

JUN 11, 2008

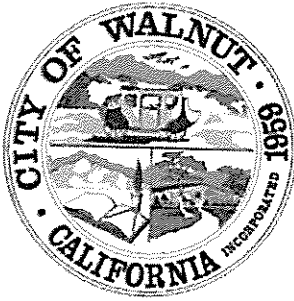

**AGENDA** ITEM 13

- Public Hearing
- Ordinance
- Consent Calendar
- Discussion

**WALNUT CITY COUNCIL**

**AGENDA DATE: JUNE 11, 2008**

**TO:** Mayor Lim and Council Members

**VIA:** Rob Wishner, City Manager *RW*  
Mary Rooney, Community Services Director *MR*

**FROM:** David Gilbertson, City Engineer *DB*

**SUBJECT:** Approval of Plans and Specifications and Authorization to Advertise and Receive Formal Bids for the Grand Avenue at Amar Road/Temple Avenue Intersection Improvement Project

**RECOMMENDATION:**

It is recommended that the City Council:

1. Declare that the project qualifies for a Class I exemption pursuant to Section 15301 of the California Environmental Quality Act Guidelines,
2. Approve the plans and specifications; and authorize the City Engineer to advertise to receive formal bids, and
3. Authorize staff to pre-order the required signal poles.

**BACKGROUND:**

The intersection of Grand Avenue at Amar Road/Temple Avenue is the busiest intersection in the City of Walnut. Due to significant traffic impacts and volumes associated with Mount San Antonio College, improvements consisting of street widening to add additional turn lanes and thru lanes are necessary.

On October 10, 2007, City Council approved a professional services agreement with RKA Consulting Group to provide professional engineering and design services for the intersection improvements at Grand Avenue and Amar Road/Temple Avenue.

In December 2007, the City was awarded a competitive grant from METRO in the amount of \$1.48 million based upon preliminary plans prepared by RKA Consulting Group.

JUN 11, 2008

ITEM 13

**STAFF ANALYSIS:**

The plans and specifications for this project will be on file with the City Clerk and are available to the public.

The project consists of the widening of the intersection of Grand Avenue at Amar Road/Temple Avenue, which includes the installation of dual left turn lanes on northbound Grand Avenue and westbound Temple Avenue (Attachment A).

The design also includes the installation of dedicated right turn lanes on eastbound Amar Road, west bound Temple Avenue and northbound Grand Avenue to allow for greater traffic flow. The addition of the dedicated right turn lane on northbound Grand Avenue is contingent upon negotiations and right of way dedication (ROW) from Mount San Antonio College, since the land needed is within the outer edges of wildlife sanctuary.

The ROW plan was suggested by Mount SAC staff as an alternative to the entry road south of the Sanctuary proposed by the City (while impacts on intersection function would have been favorable, Mount SAC staff reported that gaining approval for this improvement was not as feasible as originally projected).

The Level of Service (LOS) calculations for the intersection are provided below to identify the difference in capacity with the additional right-of-way from Mount San Antonio College to construct the dedicated right turn lane on northbound Grand Avenue, and without the additional right turn lane. The chart identifies expected delay times at the intersection.

	2008		2020	
	AM Peak Hour	PM Peak Hour	AM Peak Hour	PM Peak Hour
Current Configuration	47 second delay	54 second delay	161 second delay	184 second delay
Proposed layout <b>without</b> right turn option	39 second delay	38 second delay	46 second delay	59 second delay
Proposed layout <b>with</b> right turn option	35 second delay	37 second delay	47 second delay	51 second delay

It is clear from the chart that the proposed intersection improvements will favorably impact traffic flow, particularly as projected in the year 2020, however, the projected improvements with the addition of the right turn lane are more negligible. Once bids are obtained, staff will re-examine the right turn lane from a cost benefit standpoint and may recommend eliminating that portion of the project.

As a result of discussions with Mount San Antonio College staff, it has been requested that construction begin in October, 2008 to minimize impacts to school semesters.

In order to accommodate the widened intersection, traffic signal modifications are necessary. To that end, staff is requesting City Council to authorize the pre-order of the required traffic signal poles in order to have the poles and related equipment prior to commencement of construction. This is necessary to allow for the long lead time (approximately 14 weeks) for fabrication of the traffic signal poles.

Staff proposes to advertise for formal bids in late June. The bids received will be compiled and submitted for the consideration of the City Council for award of a construction contract. If favorable bids are received and an award of contract is made, work will begin in October, 2008 with an estimated completion of February, 2009.

**FISCAL IMPACT:**

The Engineer's Estimate for construction of this project is \$2,250,000. \*

Account No. 25-6459: \$701,000 has been budgeted in for construction.

Account No. 10-6459: \$1,488,000 (to be reimbursed with METRO grant funds).

\*The engineer's estimate exceeds current budgeted funds due to the addition of the proposed right turn lane (Mount SAC). Once formal bids are obtained, staff will request an additional appropriation if necessary.

**RELATION TO MISSION STATEMENT:**

The proposed intersection improvements will enhance civic pride by promoting public safety.

*Attachment A:* Proposed intersection layout

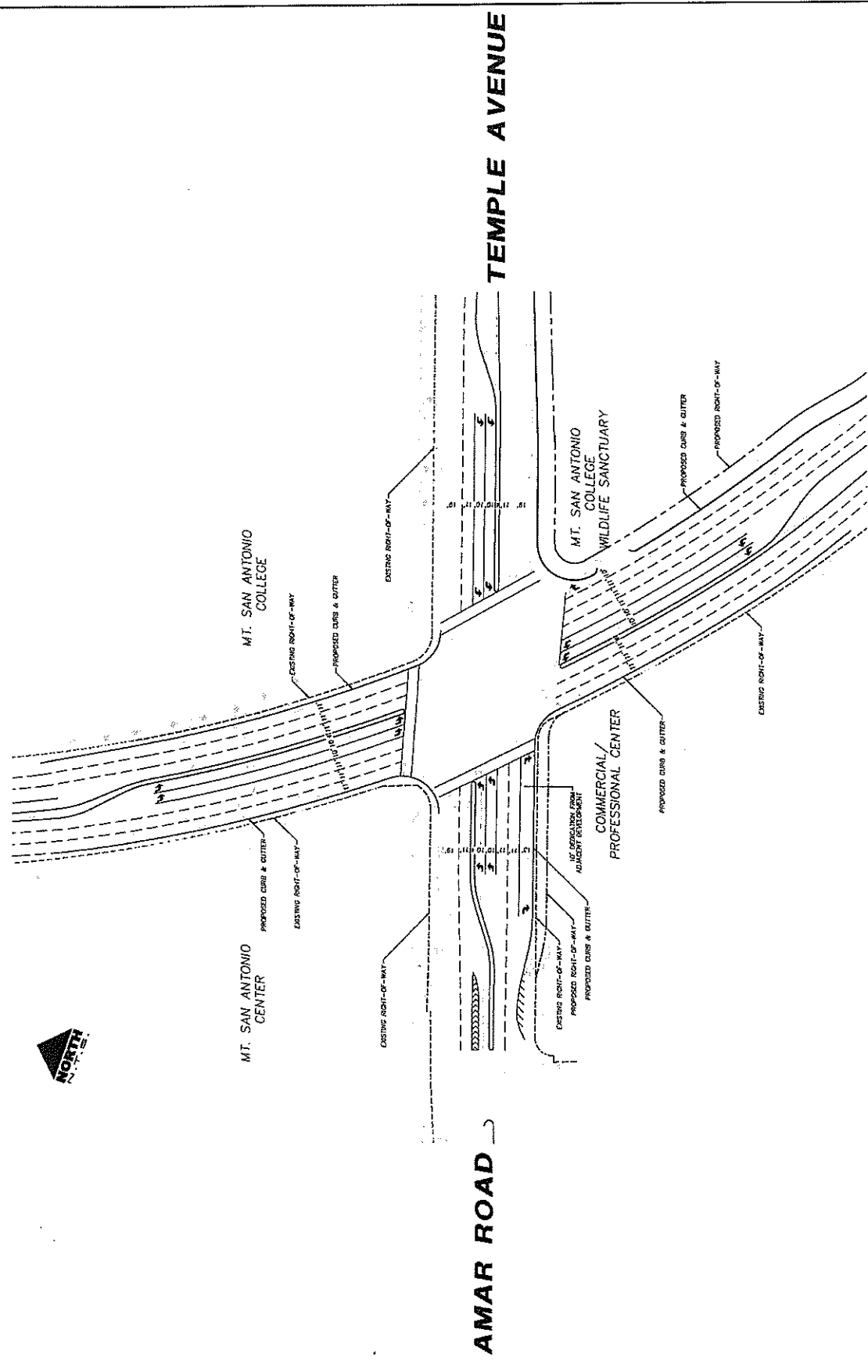

**AMAR ROAD**

**TEMPLE AVENUE**

**MT. SAC CONCEPTUAL STUDY**  
ATTACHMENT A  
**GRAND AVENUE**  
AT TEMPLE AVENUE / AMAR ROAD